

G  
R  
O  
U  
N  
D  
F  
L  
E  
E  
R

M  
E  
Z  
Z  
A  
N  
I  
N  
E

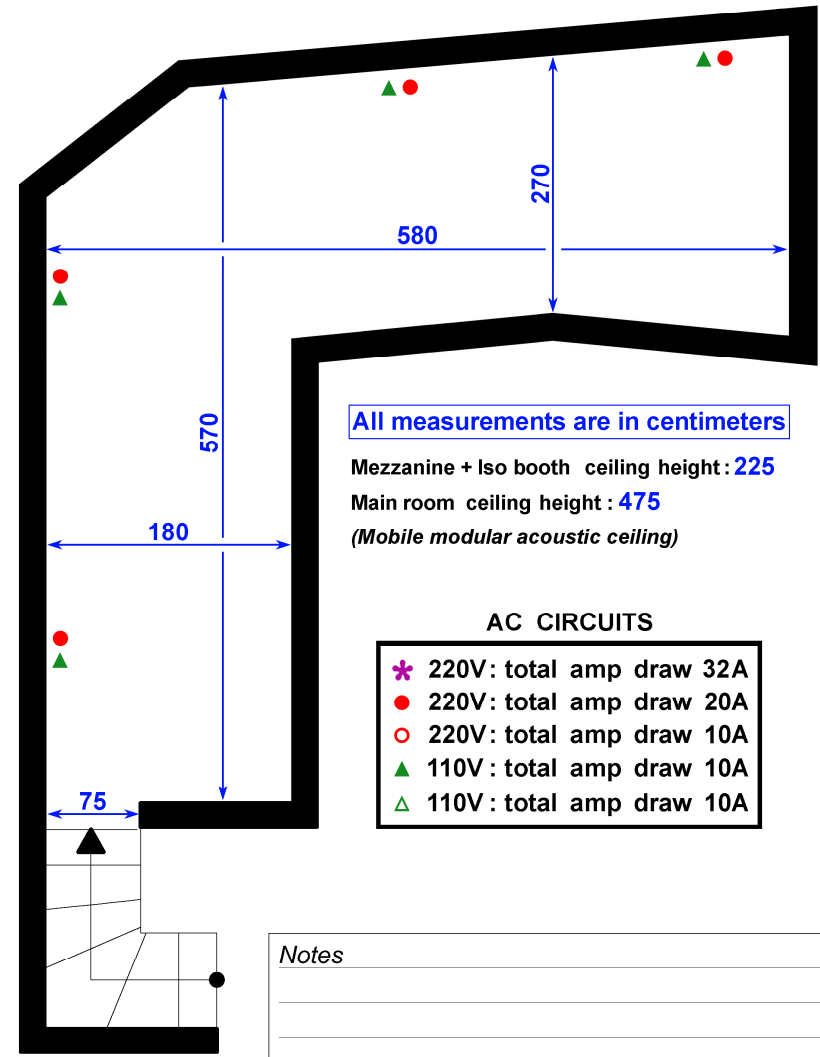

**All measurements are in centimeters**  
 Mezzanine + Iso booth ceiling height : 225  
 Main room ceiling height : 475  
 (Mobile modular acoustic ceiling)

**AC CIRCUITS**

* (Purple Asterisk)	220V : total amp draw 32A
● (Red Circle)	220V : total amp draw 20A
⊙ (Red Circle with Dot)	220V : total amp draw 10A
▲ (Green Triangle)	110V : total amp draw 10A
▲ (Green Triangle with Dot)	110V : total amp draw 10A

Notes

---



---



---



---



---



---



# Live Room Floor Plan

# GANG RECORDING STUDIO EQUIPMENT

CONSOLES :

- 1 A.P.I. 3288 (Automated Processes Inc.) 32/8/2 / Split Monitor, 32 input console filled with 550A, 553, 554 and 559 eq modules.
- 1 SOUNDCRAFT GHOST 24/8/2 .  
up to 56 monitor channels with both consoles linked.

HARD DISK  
RECORDER :

- 1 AVID PROTOOLS HD3 Accel 32 i/o version 10.2  
with NTP 570-200A Reference Clock

AUTOMATION :

- 1 OPTIFILE 2 HD Computer 64 Channels.

SYNCHRO :

- 1 AVID SYNCH HD IO
- 2 ADAMS-SMITH ZETA 3 Synchronizer (+Remote)

MULTITRACK  
TAPE RECORDERS :

- 1 STUDER A80-MkII Analog 24 TRACK (2 INCHES)
- 1 SCULLY 280 Analog 16 TRACK (2 INCHES)
- 2 SONY 3324A DASH (2x24 TRACK)

2 TRACK  
TAPE RECORDERS :

- 1 STUDER A807 Analog (1/4 INCH)
- 1 SONY/MCI APR 5000 Analog (1/4 INCH)
- 1 STELLAVOX Analog (1/2 INCH)
- 2 DAT SONY PCM R500

CUE  
SYSTEM :

**8 MONO 56 CHANNEL CUSTOM CUE SYSTEM :**  
(up to **4 STEREO CUE MIXES** or **8 MONO CUE MIXES**)  
(possibility to make **stereo &/or mono mixes** simultaneously)

HEADPHONES :

BEYER DYNAMIC : DT 150 (Z=2x250 Ohms)  
DT 102 (single hear version for strings session)

SENNHEISER : HD 25

**VIDEO :**

- 1 SONY UMATIC 5850 (+ Remote)
- 1 SONY UMATIC 5630
- 1 SONY BRAVIA KDL 55EX72X 55 INCHES TV/Monitor HD/3D
- 1 LG Blu-Ray HD/3D Hard Disc Drive Recorder
- 1 SAMSUNG DVD-HD745 DVD/SACD Player
- 1 GEFEN CAT5 1500 HDS

**MONITORING :**

- JBL 4350 (PHASE LINEAR 400, CREST 8001 power amps)
- JBL 4408 (HAFLER power amp)
- YAMAHA NS-10M STUDIO (HAFLER power amp)
- GENELEC 1031A

**FX PROCESSORS :**

- 1 LEXICON 480 L (with LARC remote)
- 1 LEXICON PCM 70
- 2 AMS RMX 16
- 1 AMS DMX 15-80 S (+ keyboard interface / chorus controller)
- 2 KLARK TEKNIK DN 780
- 1 SONY DRE 2000 (+ Remote)
- 1 EVENTIDE H 3000 SE
- 1 EVENTIDE H 910 HARMONIZER
- 2 EVENTIDE INSTANT PHASER
- 1 APHEX II (Aural Exciter)
- 1 DBX 163 (Subharmonic Synthesizer)
- 2 DRAWMER DF-320 DUAL NOISE FILTER
- 1 YAMAHA SPX 900
- 1 YAMAHA SPX 1000
- 3 YAMAHA SPX 90 II
- 1 YAMAHA REV 5
- 1 YAMAHA REV 7
- 1 EMT 140 TS Plate Reverb (with remote)
- 1 AKG BX-20 (Stereo Spring Reverb with remote)

INCLUDES ACCESS TO 2 PROPRIETARY ECHO CHAMBERS.

**EQUALIZERS :**

- 2 PULTEC EQP 1A (Tubes)
- 2 PULTEC MEQ 5 (Tubes)
- 1 PULTEC EQH 2 (Tubes)
- 1 PULTEC HLF 3C (Passive)
- 2 PULTEC MAVEC (Mic pre.)
- 4 MXR GRAPHIC (1/3 Octave 31 band)
- 1 TC ELECTRONIC M2000
- 1 GML 8200 PARAMETRIC SERIE II (Stereo)

**DYNAMICS :**

7 BSS DPR 402 (Stereo Comp)  
 2 BSS DPR 502 (Stereo Gate)  
 1 BSS DPR 504 (Quad Gate)  
 2 UREI 1176 LN Peak Limiter (Mono)  
 2 UREI LA 3A Leveling Amplifier (Mono)  
 3 EMT 156 PDM Compressor (Stereo)  
 2 RCA BA6A (Tube limiting amp.)  
 2 DBX 163  
 1 MANLEY VARI-MU (Stereo Tube Comp)  
 1 FAIRMAN Optical Controlled Tube Comp  
 1 SSL FX 638H (Stereo)  
 4 API 525 (Mono)  
 1 KLARK TEKNIK DN 60 (Spectrum Analyser)

**MICROPHONES :**

**- AKG :**  
 5 C 414 EB  
 1 C 451  
 2 D 112  
 4 D 222  
 4 D 330 BT

**- SENNHEISER :**  
 2 MKH 435T  
 3 MD 421  
 1 MD 441

**- SHURE :**  
 4 SM 57  
 4 SM 58  
 1 BETA 58  
 1 MODEL 51  
 2 SM 7  
 1 VP 88 (Stereo)  
 1 BETA 52  
 4 BETA 56  
 2 KSM 32

**- ELECTRO VOICE :**  
 1 RE 20

**- SCHOEPS :**  
 2 CM 51U (Tube)  
 2 CMT 451  
 1 SKH 54U  
 2 CMH 34F  
 1 CMT 30F

**- SONY :**  
 1 C-800 G

- **BEYER :** 1 M 88 N (C)  
1 TG-X 48

- **MELODIUM :** 4 42 B

- **NEUMANN :** 2 U 47 fet i  
2 U 87  
2 KM 84i  
3 KM 86i  
2 KM 88i  
1 SM 69 fet (Stereo)  
1 M49 B (Tube)  
1 M49 C (Tube)  
1 U47 (Tube) Long Body with VF 14  
1 U47 (Tube) with VF 14  
1 U48 (Tube) with VF 14  
1 UM57 (Tube)  
2 KM 56 (Tube)

- **INSTRUMENTS :** 1 HAMMOND B 3 Organ (+ Leslie 122 Cabinet)  
1 WURLITZER 200A  
1 FENDER RHODES Seventy-Three with Suitcase  
1 HOHNER CLAVINET D6  
1 PLEYEL GRAND CONCERT PIANO 2,74m  
1 MARSHALL JCM 900 Guitar Amp  
1 MARSHALL 1912 1x12" Cabinet  
1 VOX AC-30 1962 Copper Panel Guitar Amp